

## Elemore Colliery by David Witham

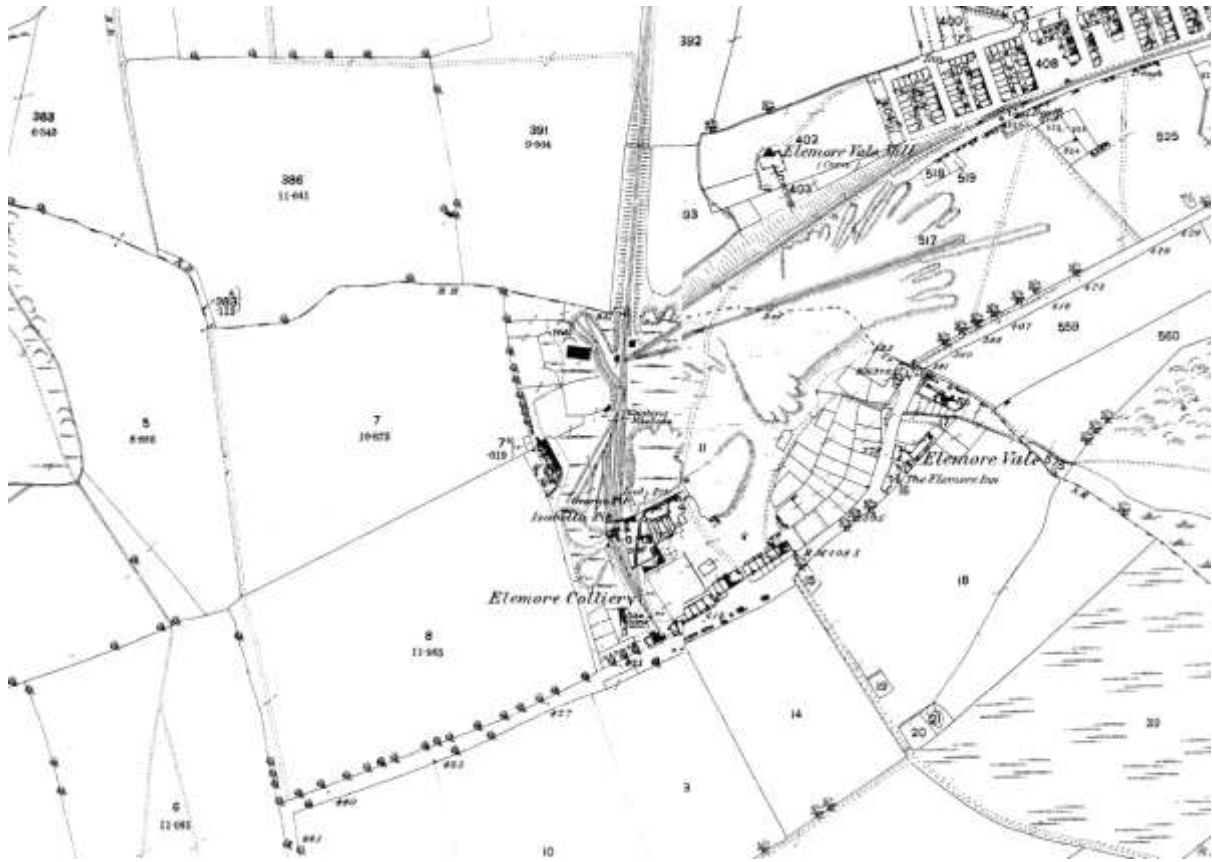

**1869** map shows primitive but busy workings with unnamed buildings near the location of the pit heap (possibly Miners Cottages?), a mass of railway lines above the Stockyard with one line leading off to the East past the Elemore Vale Mill (marked Corn) and along the Brikgarth Housing Estate running past a Coal Depot, this line continued toward the main road from Hetton to Easington A182 and stopped approx just North of the present day Easington Lane library until 1939 map, this line is not only unusual but is also unnamed with no apparent reason, other than a possible Coal Depot? Also unusual is that a small number of Coke ovens near the road in on the left of the above picture, (This was short lived as The Lyons Pit had a huge number of them but not Eppleton) a large square unnamed area to the right of the L shaped workshops (listed as Reservoir on 1896 map).

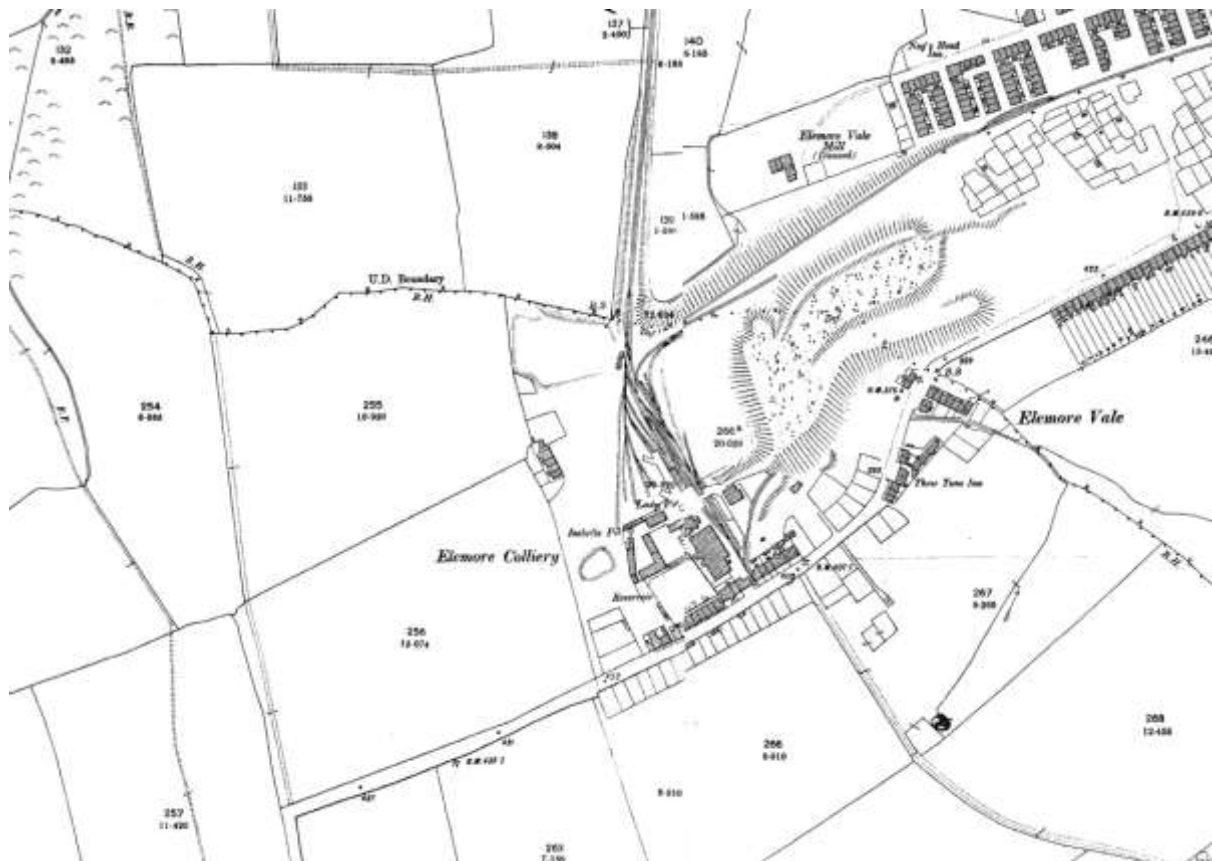

**1896** shows a much tidier site (Elemore had been abandoned a few times in its life due to Geological Problems) The Coke ovens are removed but a small spoil heap it to the left of the new Isabella Winder, The George Shaft no longer listed only known as Lady Shaft, but a large Building (biggest on site) has appeared with railway lines heading back to Elemore Lane, (Just to the left of the present day row of Lorne Street). There is an L shaped Building near the Workshops but is the opposite way around, (This could be the making of the workshops but gradually updated over the years?) The former Coal Depot still has its railway sidings but is now unnamed, However the "Nags Head Inn" is listed at the lower end of the Brickgarth, But the Elemore Mill is Disused (removed by 1939 map).

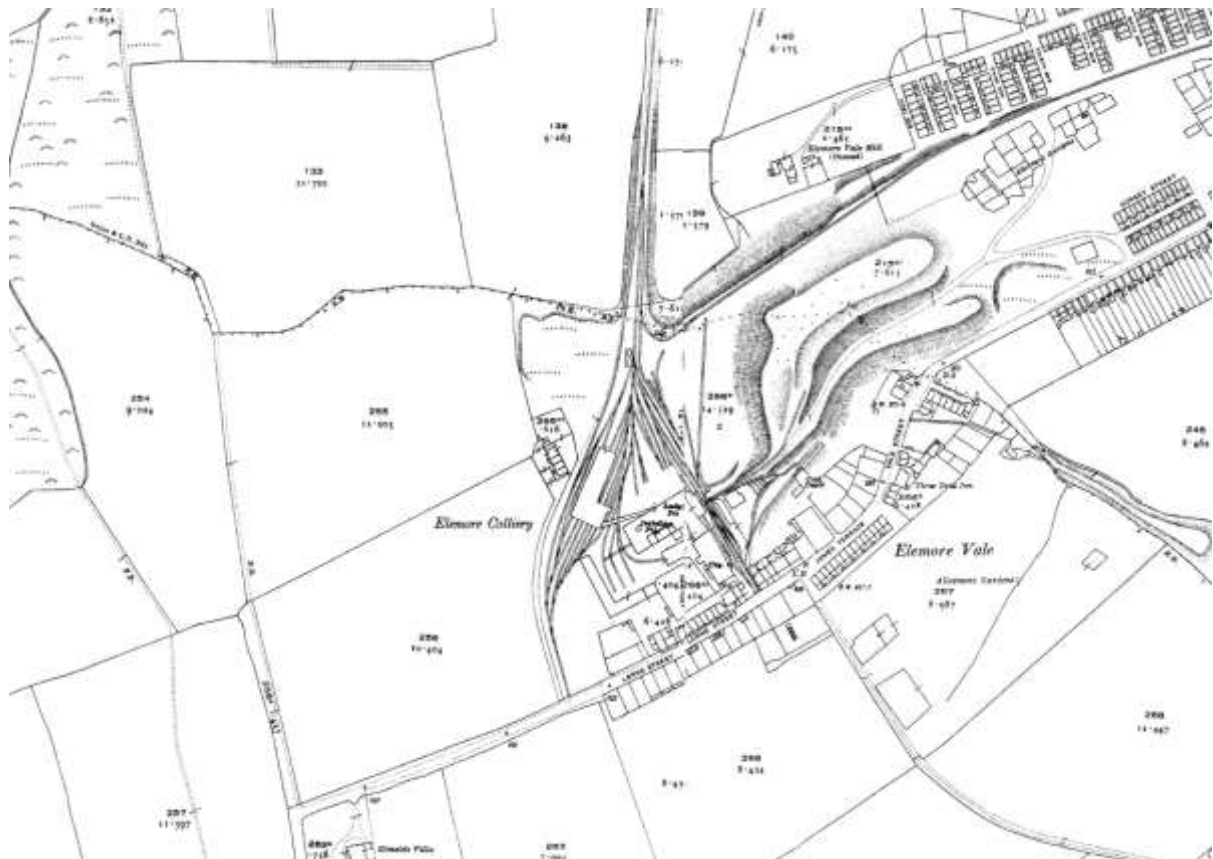

**1920** shows an expansion of Railway lines and new Screens/Washing plant and more sidings to the right of the George shaft leading upto the Road, also a new Coal Depot with its own wagon way just north of the present day Pit Baths, also worth noting is the large pit Heap to the East (not in view) which is heading toward the Brickgarth Housing Estate.

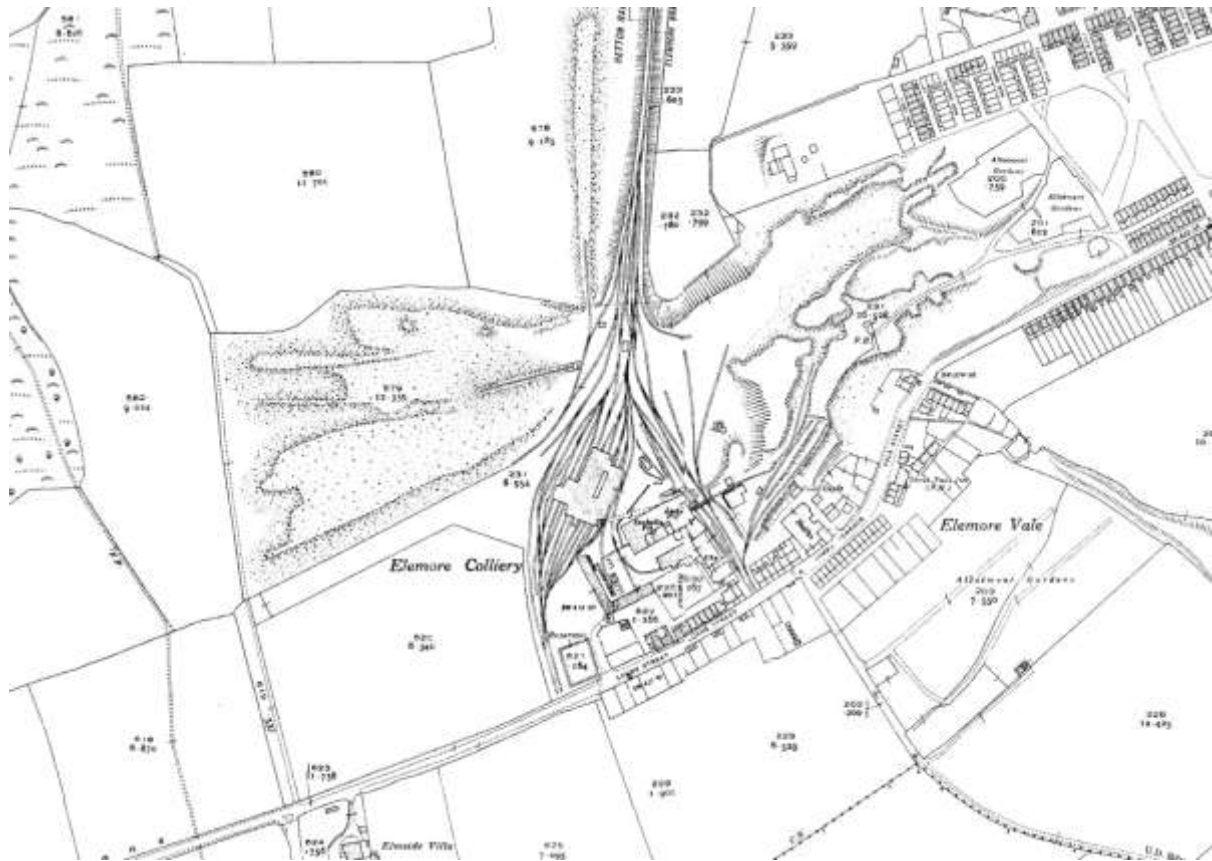

**1939**

shows the row of unnamed buildings removed near the Pit Heap, but the new Pit Head Baths and small buildings opposite are listed that would outlive the mine, The L shaped Workshops now appear as in the picture above, with the Railway lines still heading back to the Main Road (Elmore Lane) with a 2nd large Reservoir to the left (at the present day Golf Course Car Park), The former wagon way heading past the Brickgarth has been removed.



**1957** shows the arrangement of the Mine more or less settled although a few items will disappear in the following years, a new Pond is marked to the North West of the site close to the Wagon Way from the Lyons Pit, a small number of unnamed tiny buildings are dotted around (possibly weigh bridge/Magazine ?) Also the new Pit canteen to the left of James Terrace.



1960 (sadly <http://www.old-maps.co.uk/maps.html> only goes up to this year in detail) shows little difference from the earlier map, sometime later the railway lines that headed back to Elemore Lane were removed (as in the picture) and the Main line from the Lyons.